

Test suite of bowl-like objects created by a revolve operation, in the CAD-system onShape, and exported to STEP

- bowl_left_above.step: curvature point is above the toroid, to the left of the axis of revolution: $2 \cdot r_{\min} > r_{\text{maj}} > r_{\min}$, the toroidal surface is cut by a plane above the center plane of the toroid.

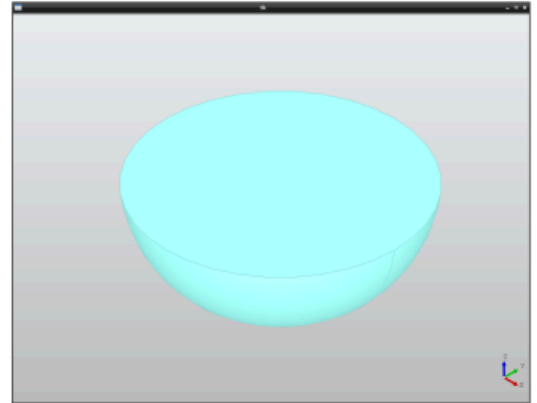

- bowl_left_below.step: curvature point is below the toroid midplane, to the left of the axis of revolution: $2 \cdot r_{\min} > r_{\text{maj}} > r_{\min}$, the toroidal surface is cut by a plane above the center plane of the toroid.

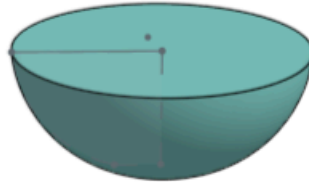
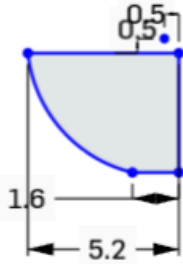
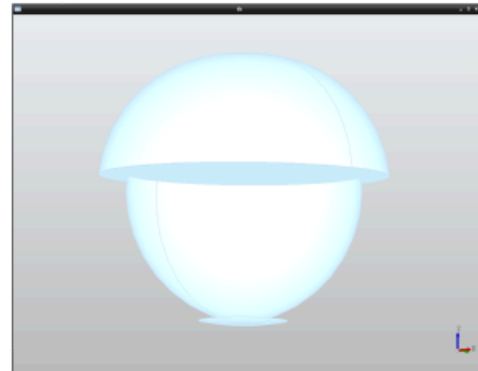
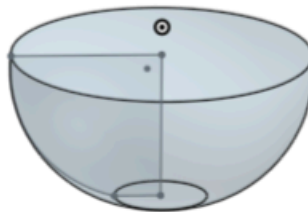
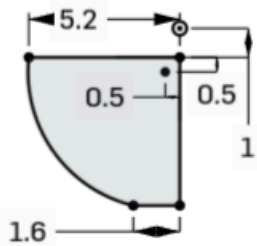

- bowl_right_above.step: curvature point is above the toroid midplane, to the right of the axis of revolution: $r_{\min} > r_{\text{maj}}$, the toroidal surface is cut by a plane below the center plane of the toroid.

center plane of the toroid.

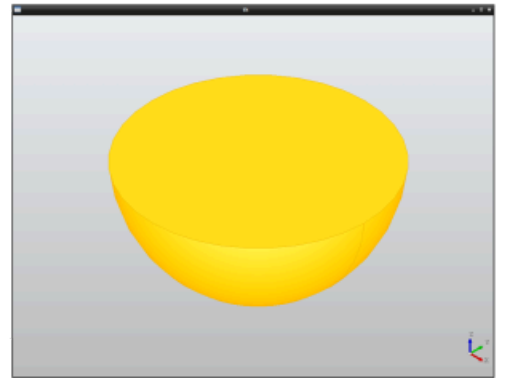
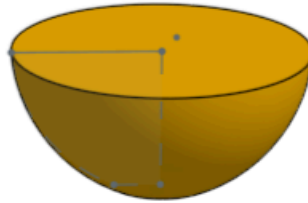
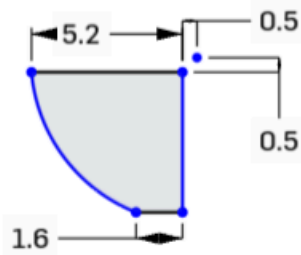

- bowl_right_below.step: curvature point is below the toroid midplane, to the right of the axis of revolution: $r_{\min} > r_{\text{maj}}$, the toroidal surface is cut by a plane above the center plane of the toroid.

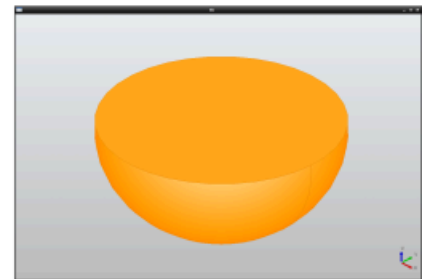
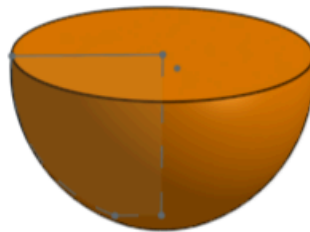
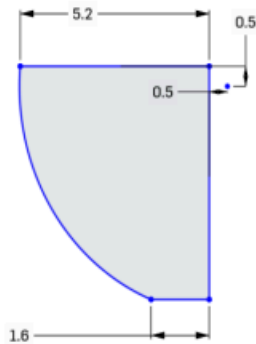

- bowl_left_below_cutout.step: curvature point is below the toroid midplane, to the left of the axis of revolution: $2 \cdot r_{\min} > r_{\text{maj}} > r_{\min}$, the toroidal surface is cut by a plane above the center plane of the toroid. An additional cut-out is made such that the curvature point is not inside the shape.

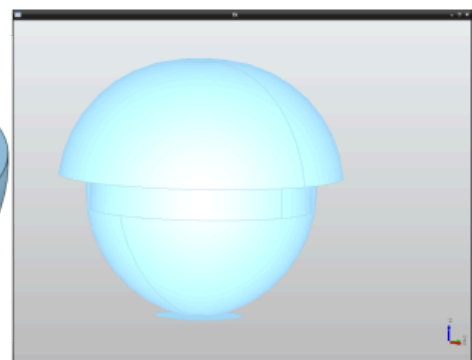
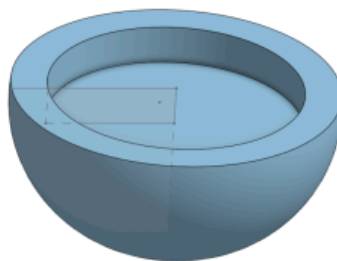
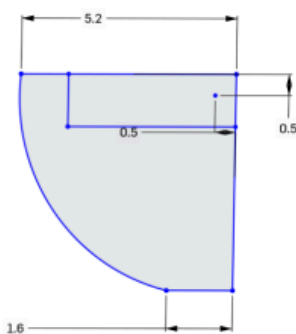

- bowl_left_below_oblcut.step: curvature point is below the toroid midplane, to the left of the axis of revolution: $2 \cdot r_{\min} > r_{\text{maj}} > r_{\min}$, the toroidal surface is cut by a plane above the center plane of the toroid. An additional cut-out is made such that the curvature point is not inside the shape.

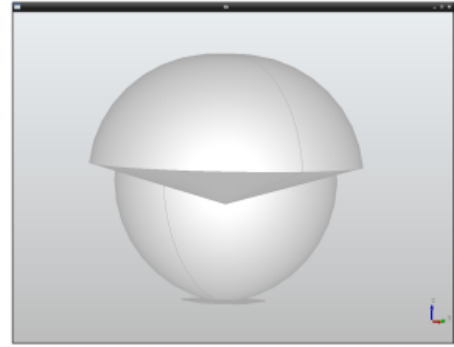
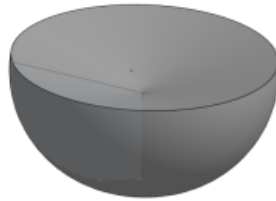
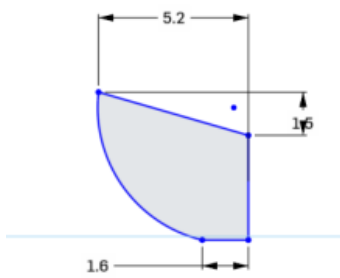

- bowl_left_below_extended.step: curvature point is below the toroid midplane, to the left of the axis of revolution: $2 \cdot r_{\min} > r_{\text{maj}} > r_{\min}$, the toroidal surface is cut by a plane above the center plane of the toroid, but the curved surface continues beyond a perpendicular plane.

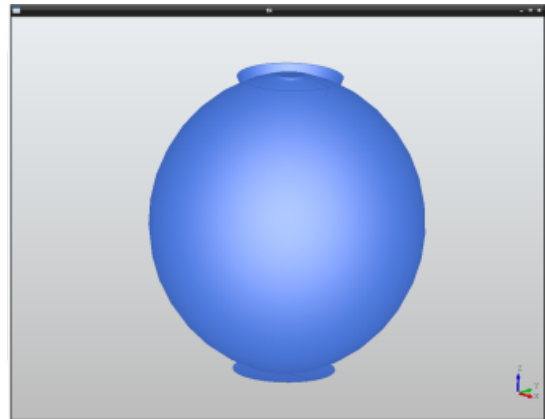
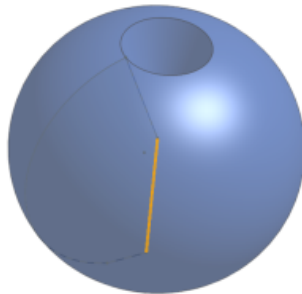
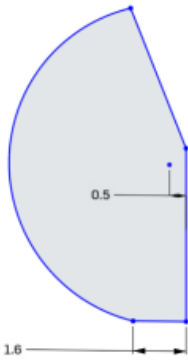

- bowl_left_below_extended.step: curvature point is below the toroid midplane, to the left of the axis of revolution: $2 \cdot r_{\min} > r_{\text{maj}} > r_{\min}$, the toroidal surface is cut by a plane above the center plane of the toroid. The curved surface extended to the axis of revolution.

